

## Hinges

### Zinc die casting, with detent

#### SPECIFICATION

##### Types

- Type **A2**: Indexing position, -90°, 0° and 180°, medium holding torque
- Type **C2**: Indexing position, -3° and 117°, medium holding torque

##### Zinc die casting **ZD**

plastic coated  
black, RAL 9005, textured finish **SW**  
silver, RAL 9006, textured finish **SR**

Locking elements / Cover cap  
Plastic (Polyacetal POM)  
temperature resistant up to 80 °C

Pin  
Stainless Steel AISI 303

Compression spring  
Spring steel



#### INFORMATION

GN 437.4 Hinges with detent hold door and covers in the given indexing position without additional mechanics. This is particularly advantageous when machines and systems must be frequently opened and closed for loading and unloading, and it is also useful for servicing or repairs. Undesirable independent closing and opening is prevented.

The -3° of the type C2 moreover ensures that the door or cover presses slightly against the housing frame when closed.

#### TECHNICAL INFORMATION

- Plastic characteristics (see page A2)

#### ACCESSORY

- Stainless Steel-Spacer plates GN 2370 (see page 1392)
- Stainless Steel-Plates with tapped holes GN 2372 (see page 1393)

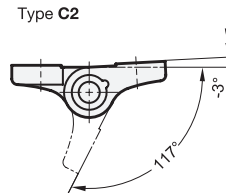
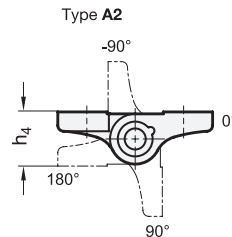
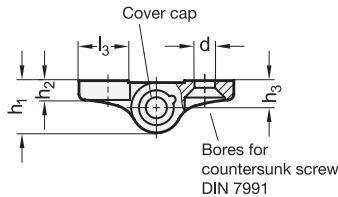
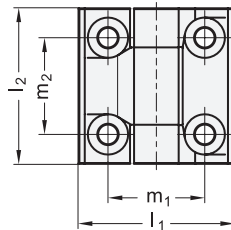

#### GN 437.4

Description	l1	l2	d	h1	h2	h3	h4	l3	m1	m2	max. holding torque MH ± 10% in Nm	
GN 437.4-ZD-60-60-A2-SR	60	60	8.3	18.5	7.5	9.5	19	20	36	36	1	155
GN 437.4-ZD-60-60-A2-SW	60	60	8.3	18.5	7.5	9.5	19	20	36	36	1	155
GN 437.4-ZD-60-60-C2-SR	60	60	8.3	18.5	7.5	9.5	19	20	36	36	1	155
GN 437.4-ZD-60-60-C2-SW	60	60	8.3	18.5	7.5	9.5	19	20	36	36	1	155